

True I.D.

A South African Identity Verification Solution

A Mobile Application



The True ID User Guide

www.trueid.co.za

A product of V-Report a Division of IdentiRisk South Africa



In this presentation our aim is to show you what True ID is, how it works and what reports you receive.

Let us Begin....

You will be able to find True ID in the Google Play store



Once you have downloaded the App from the Google play store you will find an Icon on your screen.

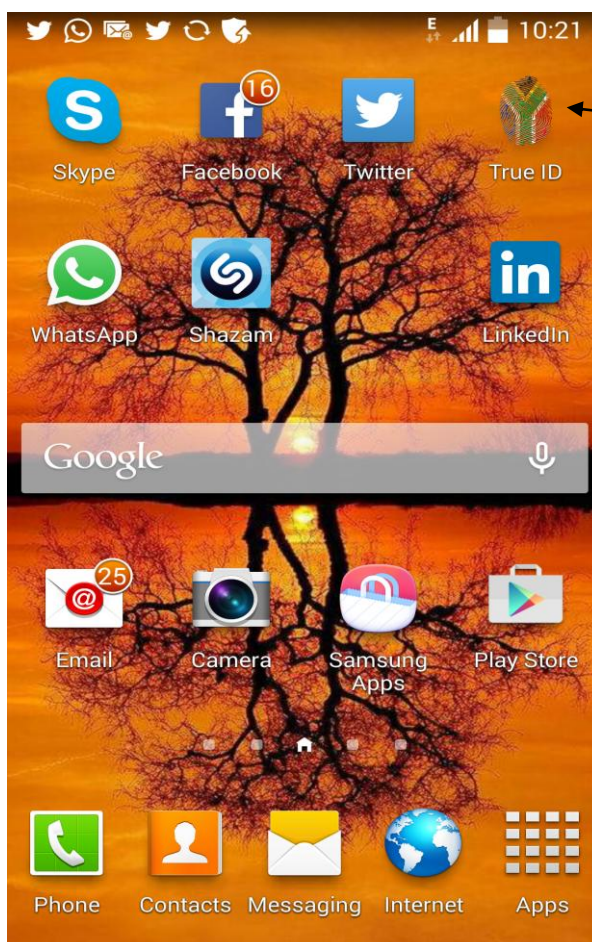



You proceed to click on this icon and the True ID application will open. On this page you will see a red login button please proceed to click on this button. To be able to use the True ID application you need to be a registered vetted client of V-Report. Our website can be found at www.v-report.co.za.

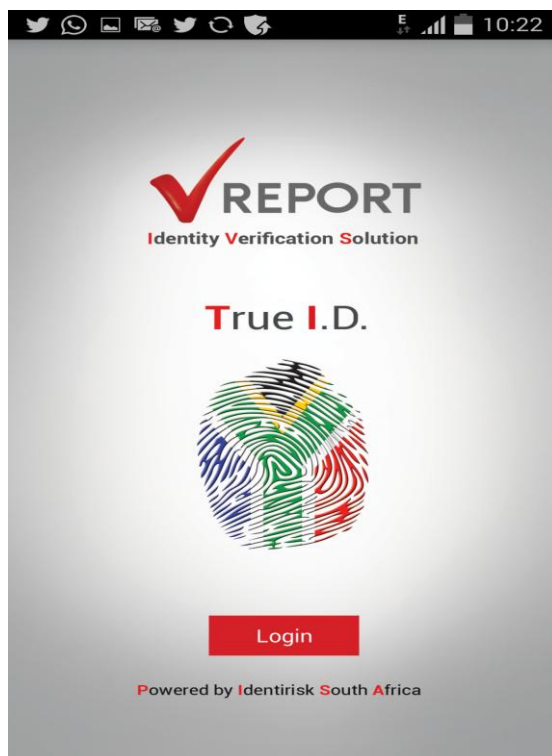

You now find yourself at our login screen. When logging into True ID the system will verify that you have a valid V-Report account and that the account is in good standing. Here you insert the login details which were provided to you at signup and that you also use to login to the V-Report website.

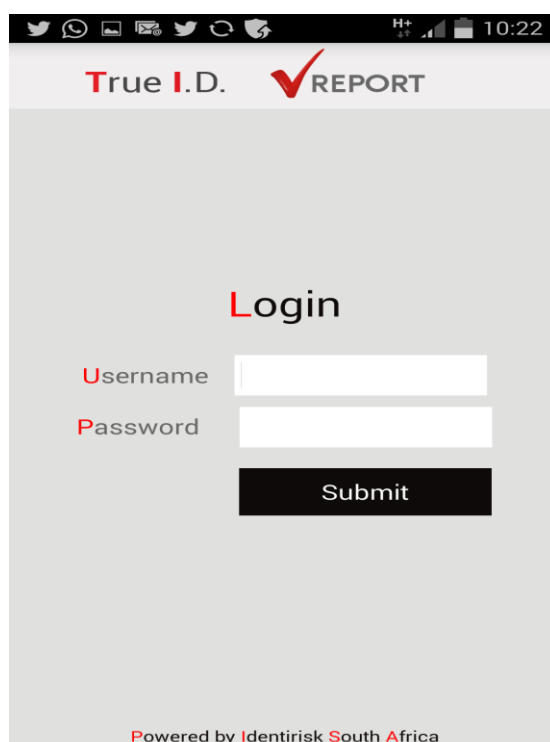



Personal Information Capture

On this screen please capture the Individuals name, surname, ID number, and the reason for the verification and then obtain consent from the Individual. Please read the consent to the Individual when obtaining consent so that they fully understand and are aware of what is happening and what this verification is for. Various forms of legislation including but not limited to the POPI Act require that consent be obtained freely and willingly from the Individual.

The screenshot shows a mobile application interface for 'True I.D. REPORT'. The top status bar includes social media icons (Facebook, Twitter), a camera icon, and the time 14:45. The app header features the 'True I.D.' logo and a red checkmark icon followed by the word 'REPORT'. The main heading is 'Personal Information' with a sub-instruction '(Please Capture the Individuals Information Here)'. The form contains the following fields and elements:

- Name**: A text input field.
- Surname**: A text input field.
- ID Number**: A text input field.
- Consent**: A checkbox followed by the text 'Consent Clauses'.
- Client Branch**: A dropdown menu with 'Sales' selected.
- Reason for Verification**: A dropdown menu with 'SELECT' as the current selection.
- Submit**: A red button with white text.

At the bottom of the screen, it says 'Powered by Identirisk South Africa'.



Consent Clauses

All Individuals that are identified using the True ID application and system needs to give consent for this process to take place. Please ensure that they read or are read these clauses as they are binding on all parties concerned and are for the protection of both True ID / V-Report and you our client. Once read please simply proceed to click on cancel to be taken back to the Personal Information Capture page.

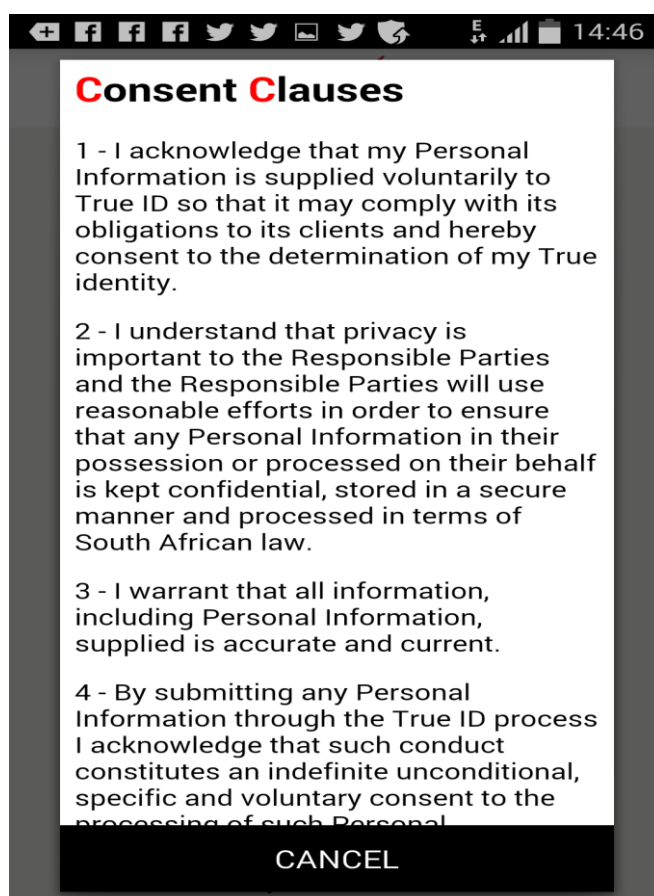



Reason for Verification

For every capture that is done using True ID a reason has to be provided. It is here that you make this selection. This selection will be shown on the order that is created for audit purposes in future should it be required.

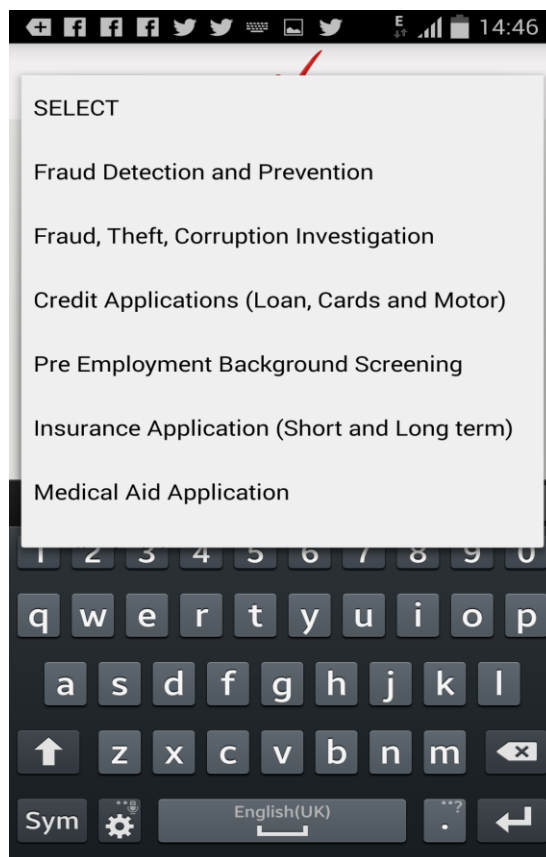



ID Document Capture

A copy of the ID document is taken for reference purposes and also to complete the facial recognition and verification process if no driver's licence is scanned. Please ensure that when taking the photograph it is a vertical photograph and simply click save on your Smartphone.

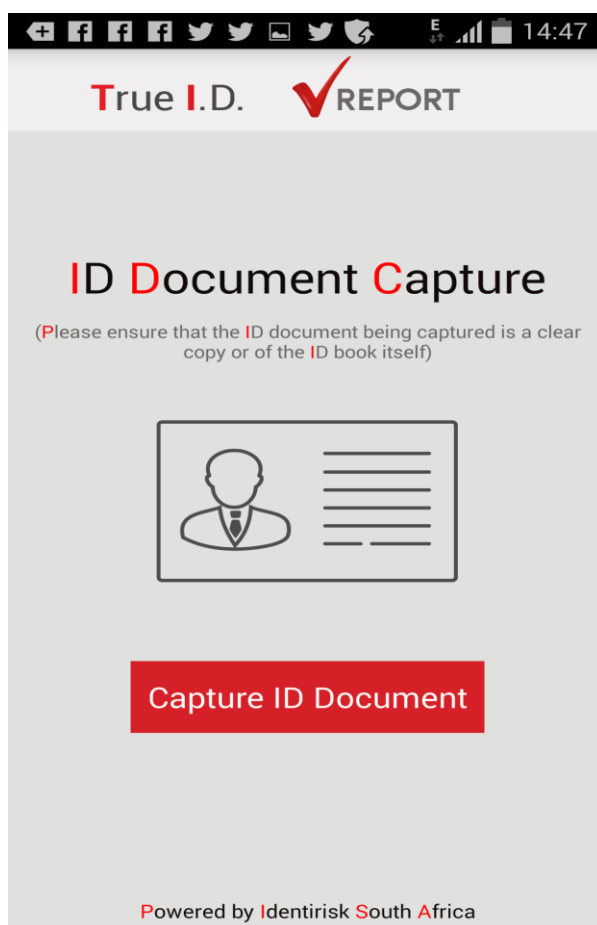



Face Capture

An ID type photograph is then taken of the Individual for record and face recognition and verification purposes. This image will be used for our facial recognition and verification biometric system.

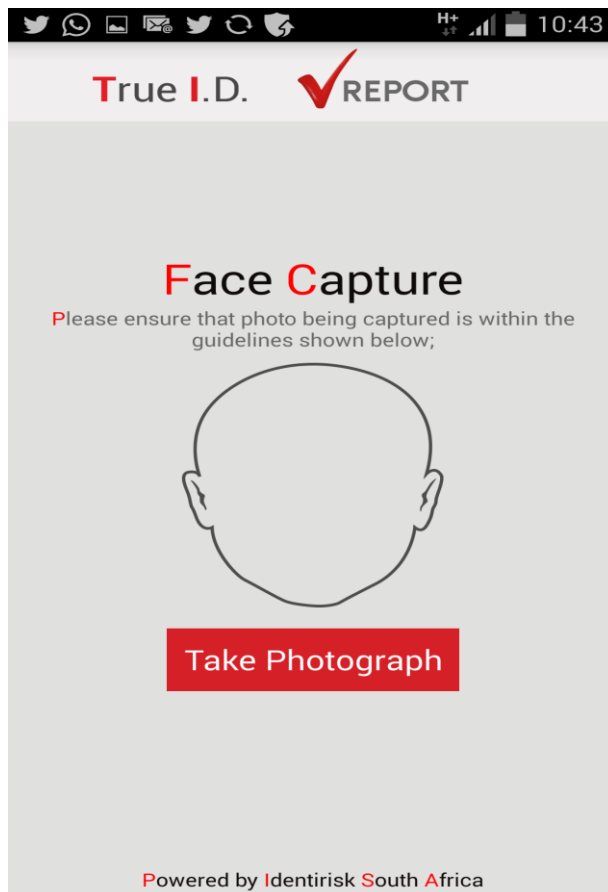



Fingerprint capture

You enter the wonderful world of touch less fingerprint biometrics True ID is one of the few companies worldwide that have the ability to capture fingerprints using your smart phones camera and autofocus functionality. We capture three fingerprints and then use the world leaders in fingerprints biometric technology “Innovatrics” to complete our matching, searching, de-duplication and saving of our FBI WSQ fingerprint to our secure database. The transfer of the fingerprint is done securely from mobile device to our secure server using 256 Bit AES Encryption. Once a fingerprint is on our database we will with 100% certainty obtain a guaranteed result on every future hit on the fingerprint within True ID.

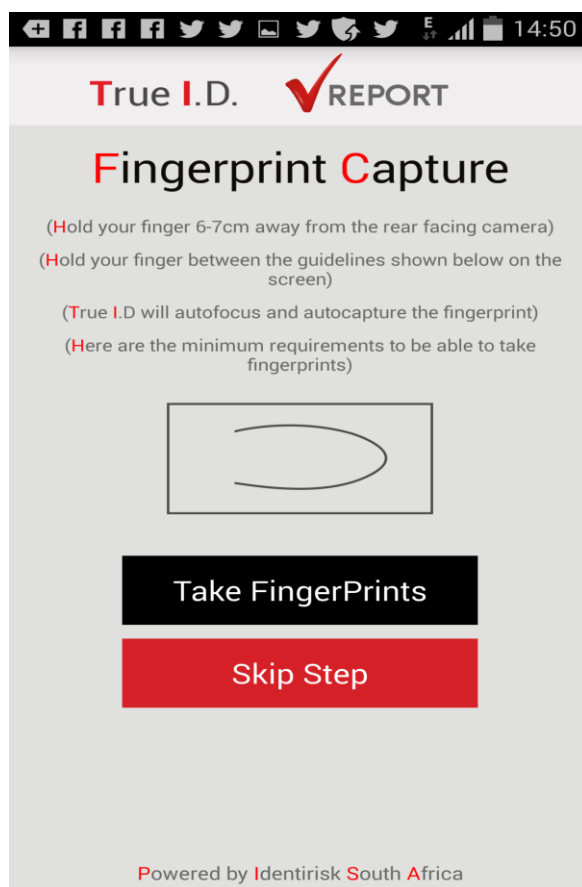



Fingerprint finger selection

It is now that you select which finger will be used for fingerprint capture. We suggest that use either the left or right hands index fingers for ease of capture.

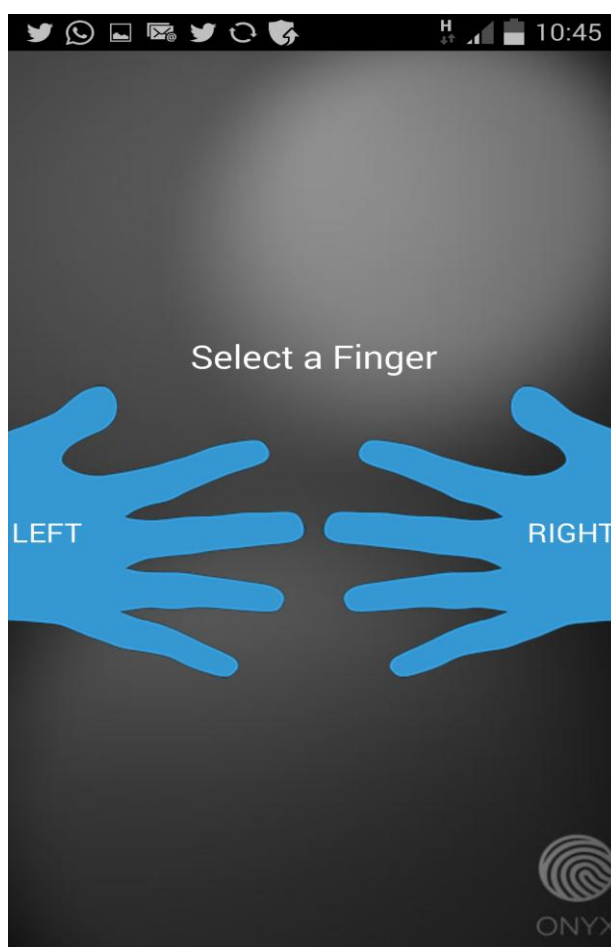



Fingerprints (How to Capture)

On the fingerprint capture page you will see the ellipse /guide in which you need to ensure that the Individuals finger is correctly angled showing the whole finger as well as ensuring that the finger is between the guide shown on screen. Once you have the finger correctly positioned the system will autofocus on the finger and the guide / ellipse will turn green and the system will automatically take the fingerprint. There is no manual intervention in this process.

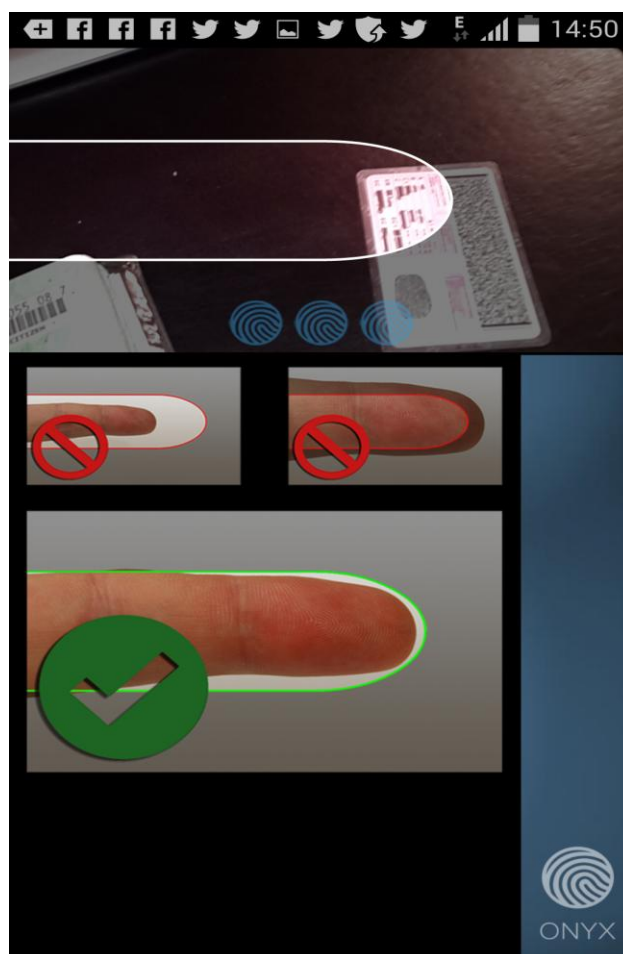



Fingerprint Confirmation (Match or No Match)

On screen you will see two fingerprints and in green **“Match Confirmed”** if you get an Unconfirmed Match you are welcome to retry the fingerprint capture process, there is a section on the bottom left hand side of the app to do this, if you are happy the click **“Save Fingerprint”** on the bottom right.

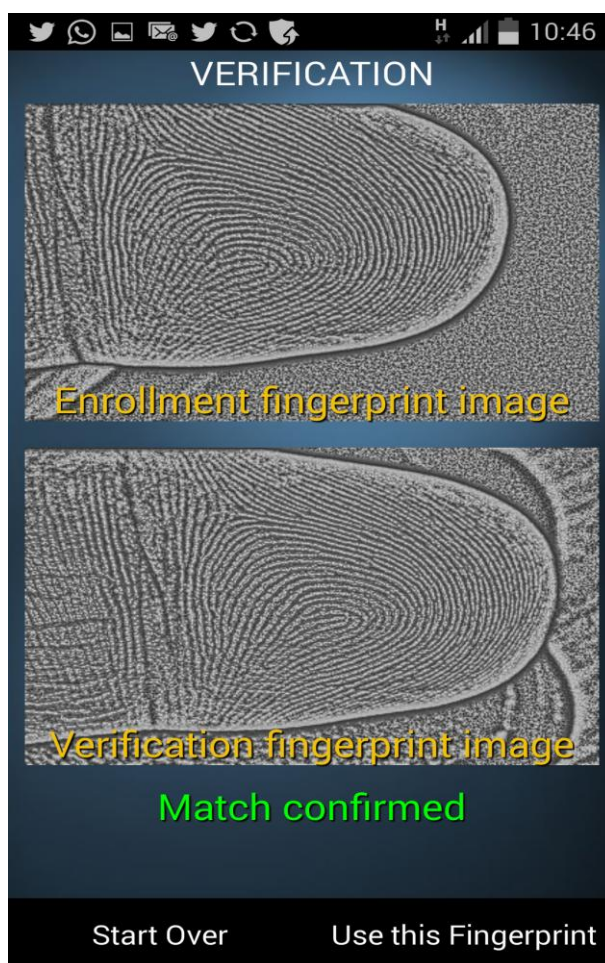



Data and Photo Retrieval

True ID now executes and obtains all the data and photographs required, it collates it into a readable report and this report is then shown on your Smartphone screen, the same report is then sent in PDF format to your registered e mail address with V-Report. This process can take up to (1 --- 2) one to two minutes so please be a little patient, it is worth the wait.

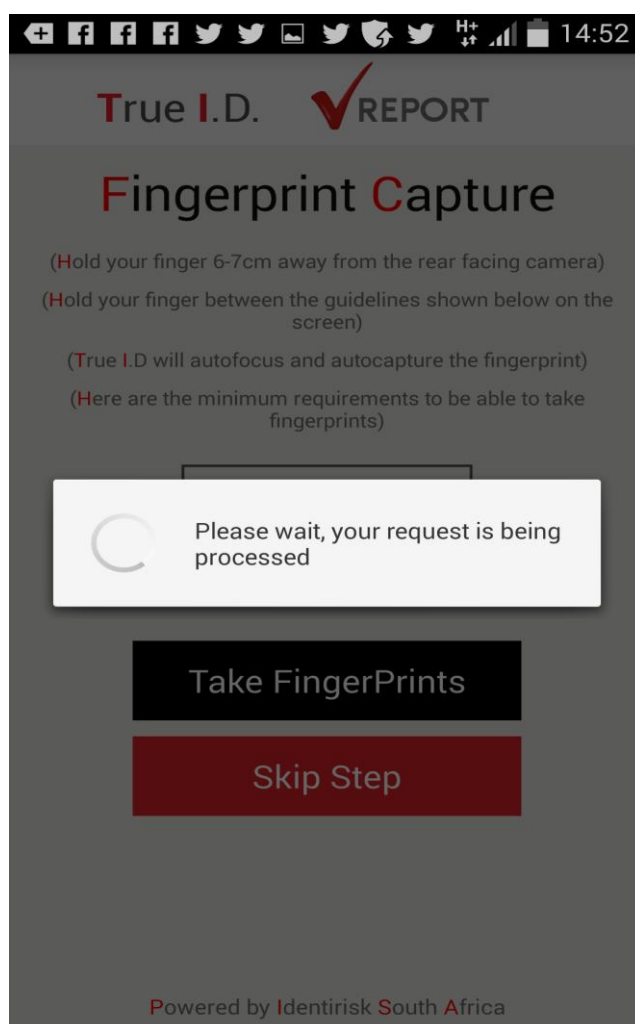



What is in the True ID Report?

Identity Verification

This part of the report confirms the Individuals biographical information on file at SA Home affairs including the issue date of the identity document. This date can be used to see if the identity document is fraudulent or not. Shown side by side you will find the ID Document of the Individual plus the photograph taken for comparison purposes.

True I.D. REPORT

Identity Management Report
Identity Verification

SA Home Affairs **Face Captured**

Name : [Redacted]
Surname : [Redacted]
ID Number : [Redacted]
Date of Issue : 1993-11-18
Validity : VALID
Date of Birth : [Redacted]
Age : 48
Gender : Female
Citizenship : South African

Powered by Identirisk South Africa



Drivers Licence Results

(These results and Photographs will only be shown if a driver's licence barcode was scanned in the capture process)

On these results you will find the most recent photograph on file as well as confirmation of the Initials, surname and ID number of the Individual you will also receive all the data concerning the drivers licence. This is a great way to reduce fraud by receiving this photograph.

The screenshot shows a mobile application interface for 'True I.D. REPORT'. The title is 'Drivers Licence Verification Report'. The report contains the following information:

- Photo on File :
- First Name :
- Full Name :
- ID Number :
- Date of Birth :
- Document Number : 40010
- Document Type : SADL
- Gender : Female
- Initials :
- Last Name :
- P I Number :
- Licence Valid From : 2010-10-07

Powered by Identirisk South Africa



True I.D.  REPORT

Drivers Licence Verification Report

Last Name :

PI Number :

Licence Valid From : 2010-10-07

Licence Valid To : 2015-10-11

Country of Issue : ZA

Place of Issue : ZA

Drivers Licence Type : 2

Licence Identification Number : 1

PDP Permit Category : No Result

PDP Permit Valid : No Result

Restrictions : 0

Vehicle Code : EB

Vehicle First Issue : 2000-10-10

Vehicle Restrictions :0

[Next](#)

Powered by Identirisk South Africa



Facial Recognition and Verification

True ID makes use of state of the art facial recognition and verification technology to complete this process. We make use of the photograph taken of the Individual and the photograph received from the driver's licence scanning to complete this verification. Should a driver's licence not be scanned True ID then make use of the photograph within the ID document captured to complete the verification. True ID will be able to confirm without a doubt if they are one and the same person.

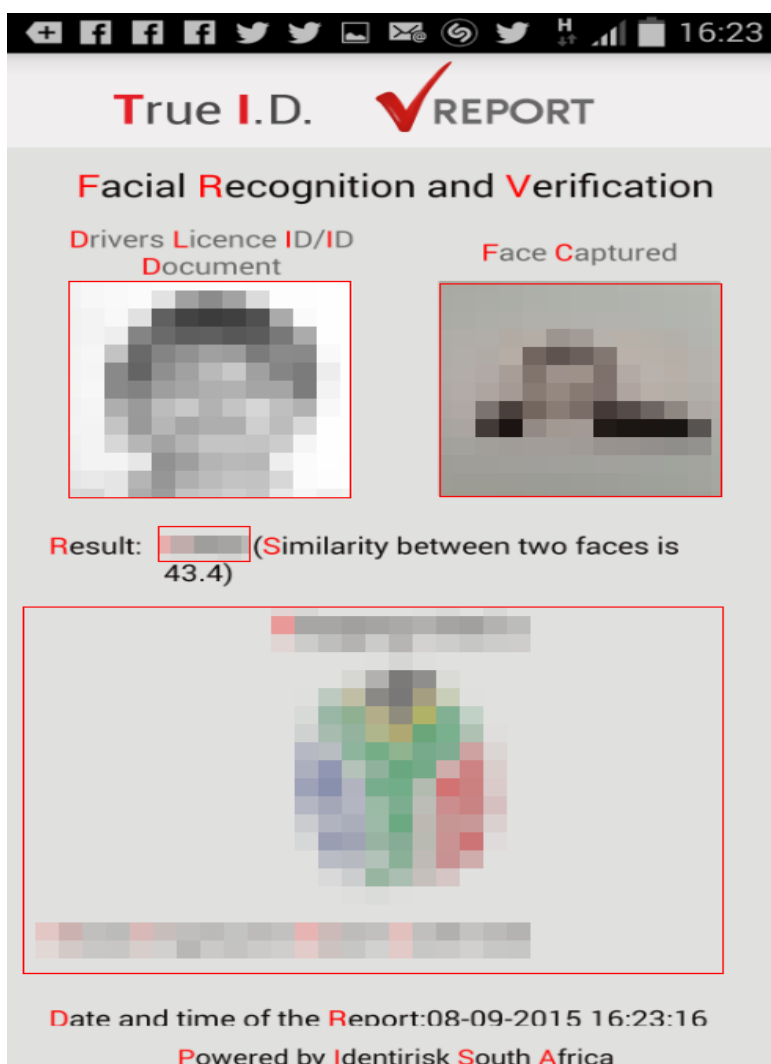



Fingerprint/s

Our last result on the report is the fingerprint match, we show the results of our matching process which occurs on the mobile device and on our secure server. Here we show if the fingerprint matches or not and if it is already on our database or if it is a first time enrolment. For security reason we will always show a default image here and never the actual fingerprint of the Individual.

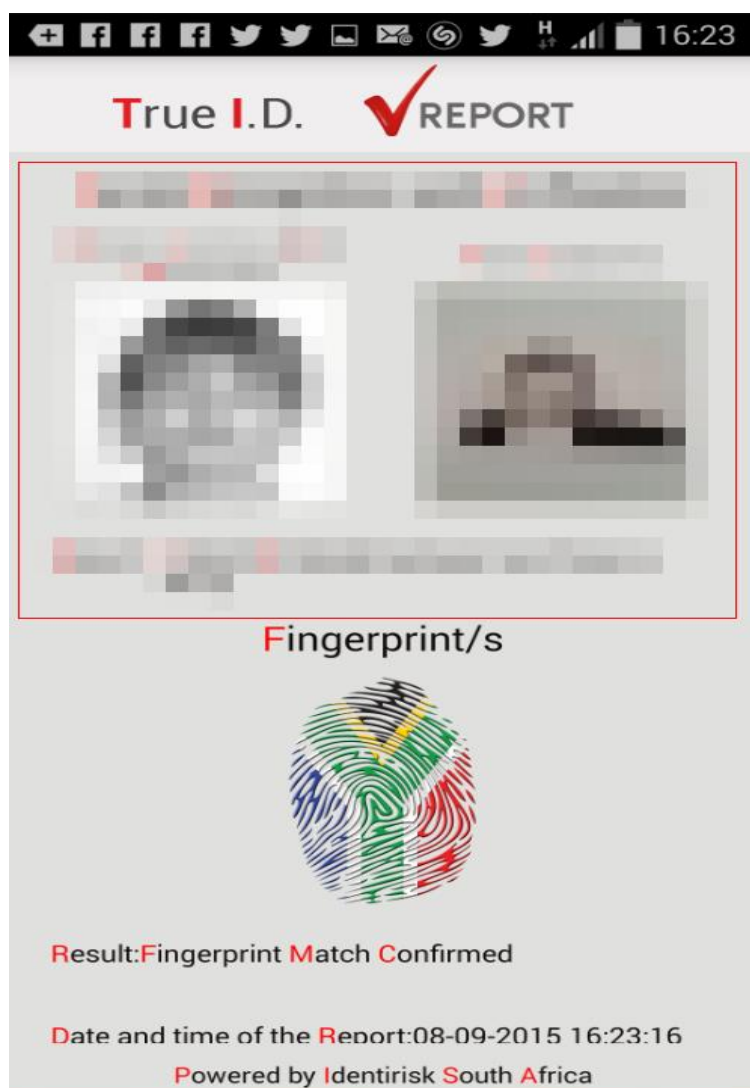



Date & Time of the Report

True ID will always record and show the date and time of the report for record purposes. You never know when in future you may require this.

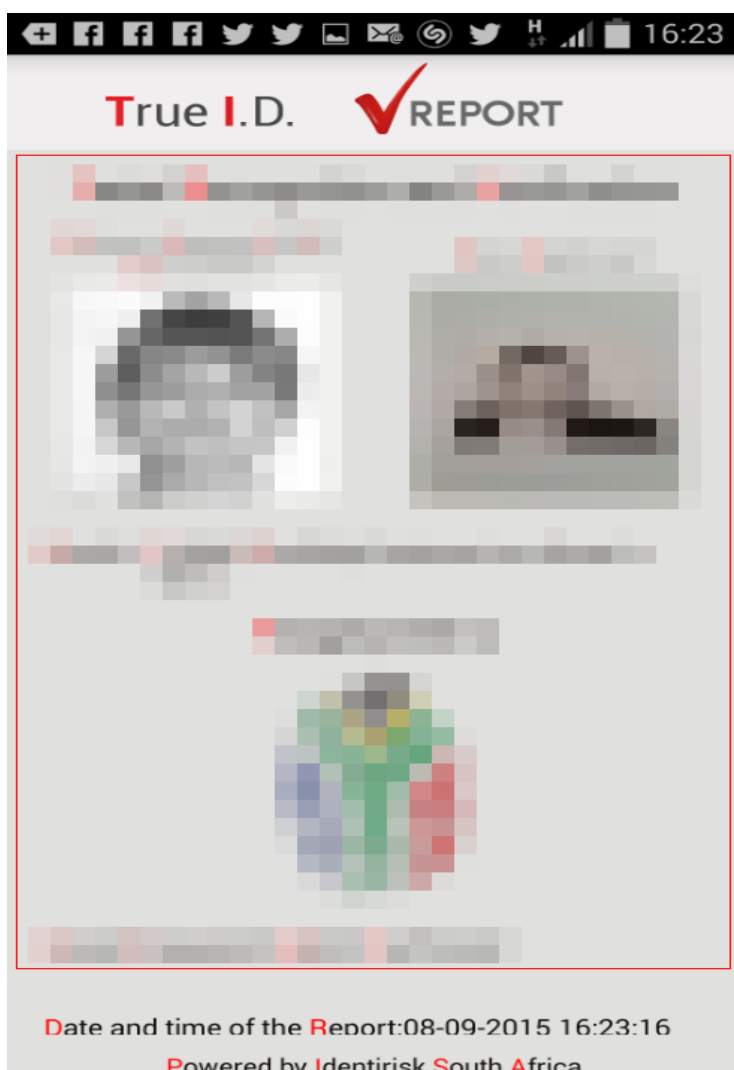



New Report

You will find on the bottom right hand side of the page a button called “New Report”. By clicking on this button you will be taken to the “Personal Information Capture” page of the app should you wish to proceed with a new Individual capture?

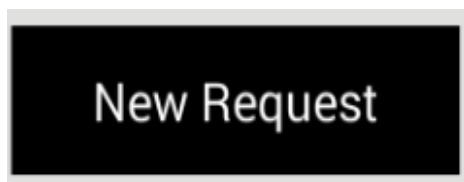

Logout

By clicking on this button you will be logged out of the True ID app.

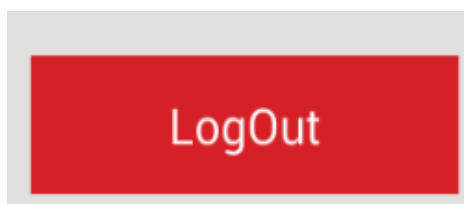



Access to the V-Report website

By making use of the True ID application you will also have access to the V-Report website where you have access to our full range of products that you are able to purchase from. You will find V-Report here <http://www.v-report.co.za>

Home | Individual's | Clients | Register Now | FAQ | Identity Theft Insurance | Web Security | Partners | Contact Us

V-REPORT

Chat with V-Report

Enter keyword

SIGN IN

Jobseeker Client

Email ID:

Password:

Forgot Password?

Jobseeker Login Only

Jobseeker Login Only

New to V-Report? Register Here

Procure Assist

SEARCH FOR CERTIFICATION | PRE EMPLOYMENT SCREENING | ACCOUNTING SERVICES

CANDIDATE INTEGRITY PROFILE | VENDOR VETTING

APPTRACK | PROPERTY VERIFICATION

CRIMINAL, FRAUD & FORENSICS | VIRTUAL RECRUITER

Should you have any questions regarding True ID please feel free to contact Shane Meintjes on info@trueid.co.za or on (011) 432-4416 / 8441